

Appendix Figure 3: Thames Defences: Cliffe Fort: Plan on Top of Roof 1899 ©The National Archives: WO78/4963

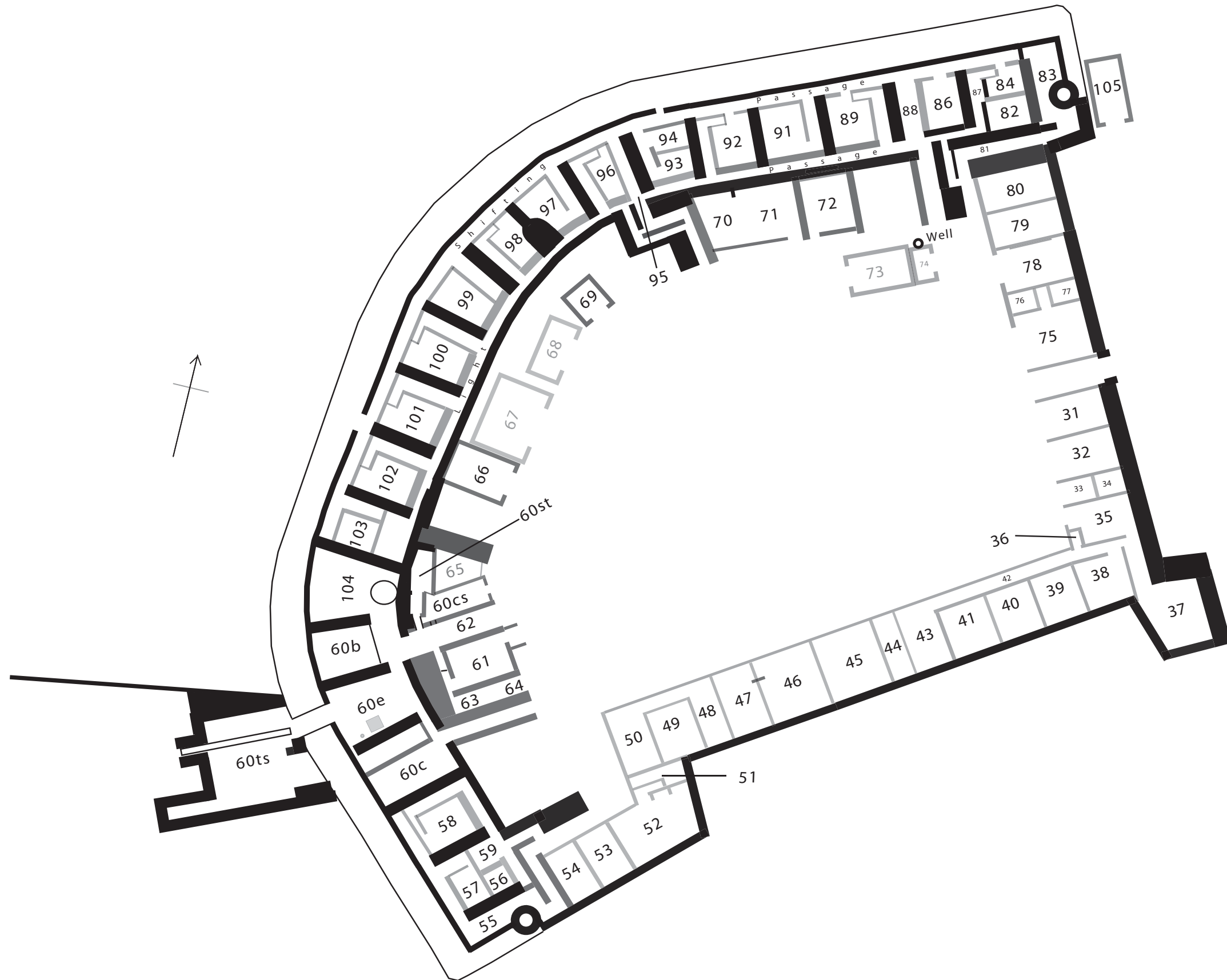

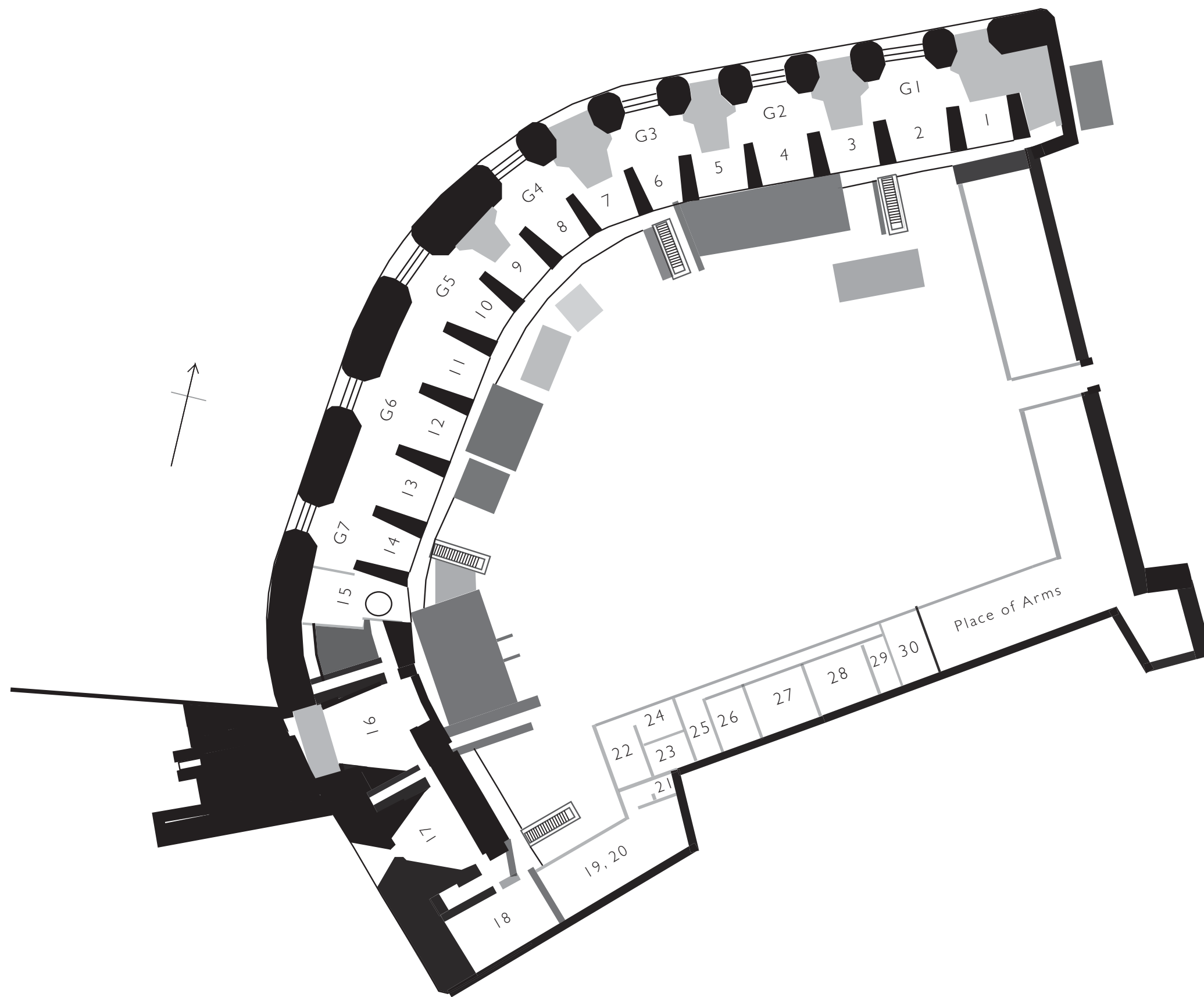

Appendix Figure 4: Basement plan with rooms numbered as mentioned in the text based on *Thames Defences: Cliffe Fort: Plan of Magazines, Drains etc 1899* ©The National Archives: WO78/4963



Appendix Figure 5: Gun floor plan with areas numbered as mentioned in the text. Based on Thames Defences: Cliffe Fort: Plan of Gun Floor 1899 ©The National Archives: WO78/4963

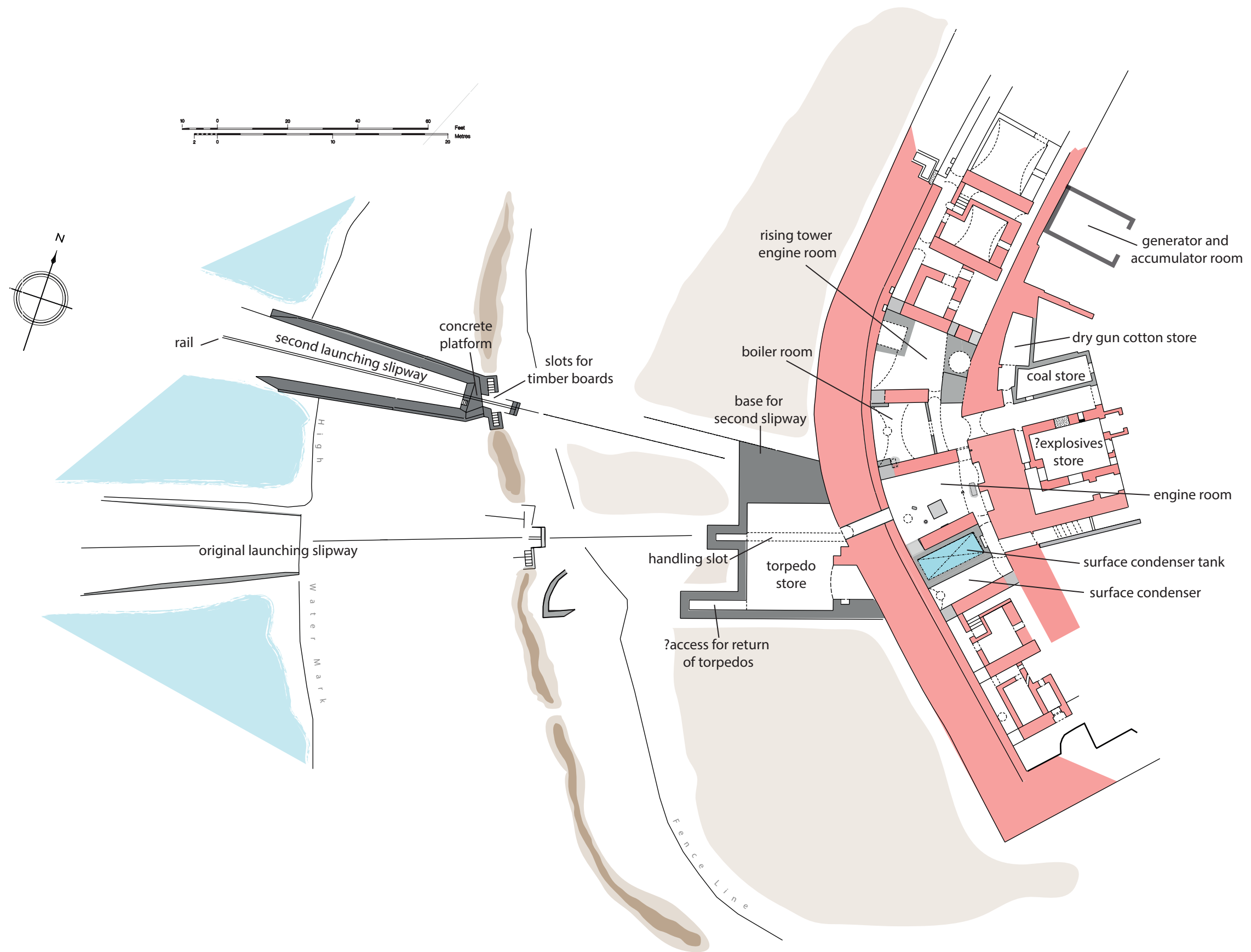

Appendix Figure 6: Sketch plan of basement level of Brennan Torpedo Installation based on information detailed in this report, Pattison (1993) and TNA: WO78/4963. (NB Original fort fabric in red, additions for the Brennan Torpedo in grey, dotted lines indicate overhead detail).



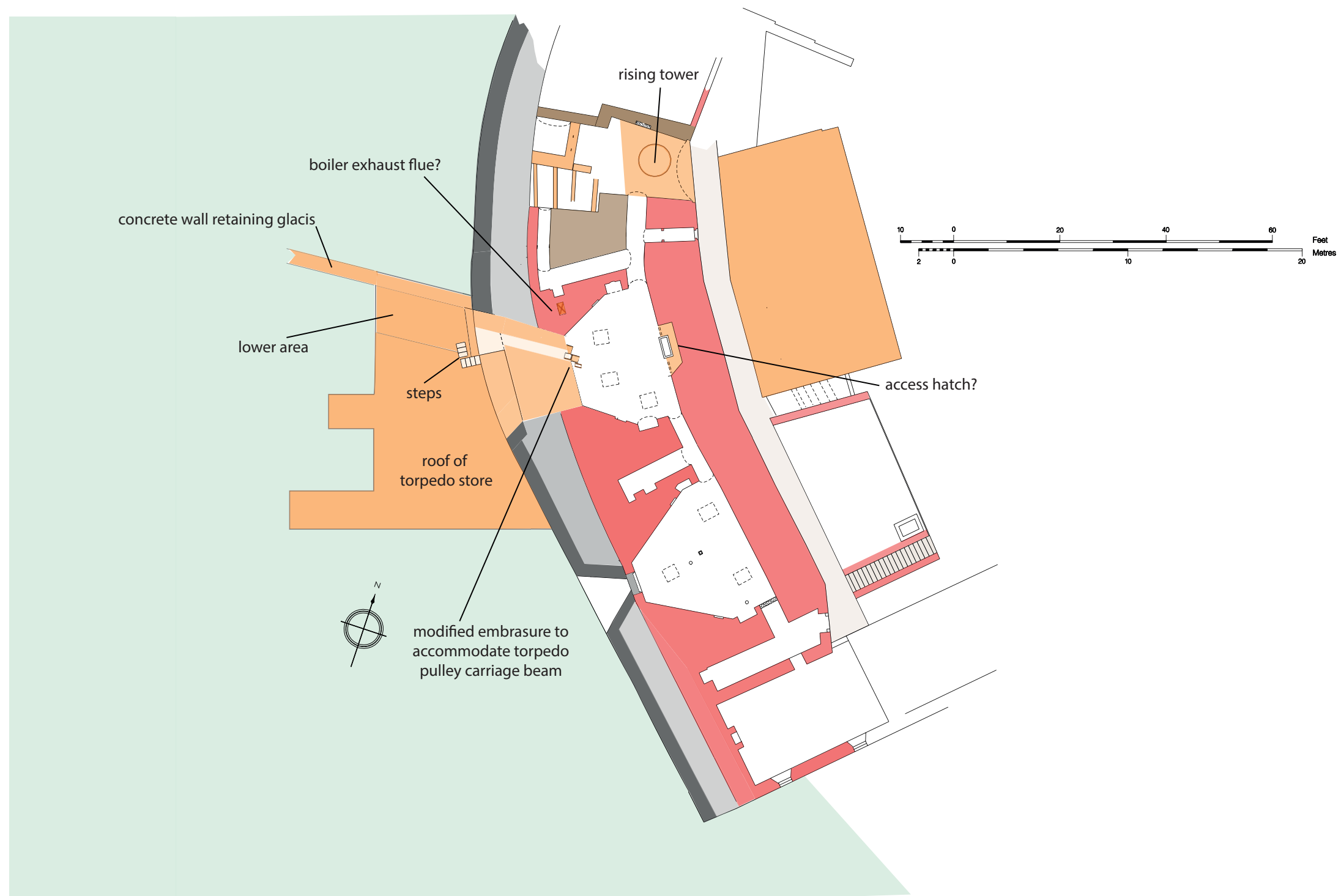

Appendix Figure 7: Sketch plan of gun floor level of Brennan Torpedo Installation based on information detailed in this report, Pattison (1993) and TNA: WO78/4963. (NB Original fort fabric in red and grey, additions for the Brennan Torpedo in orange, dotted lines indicate overhead detail, modifications for QF battery in brown).

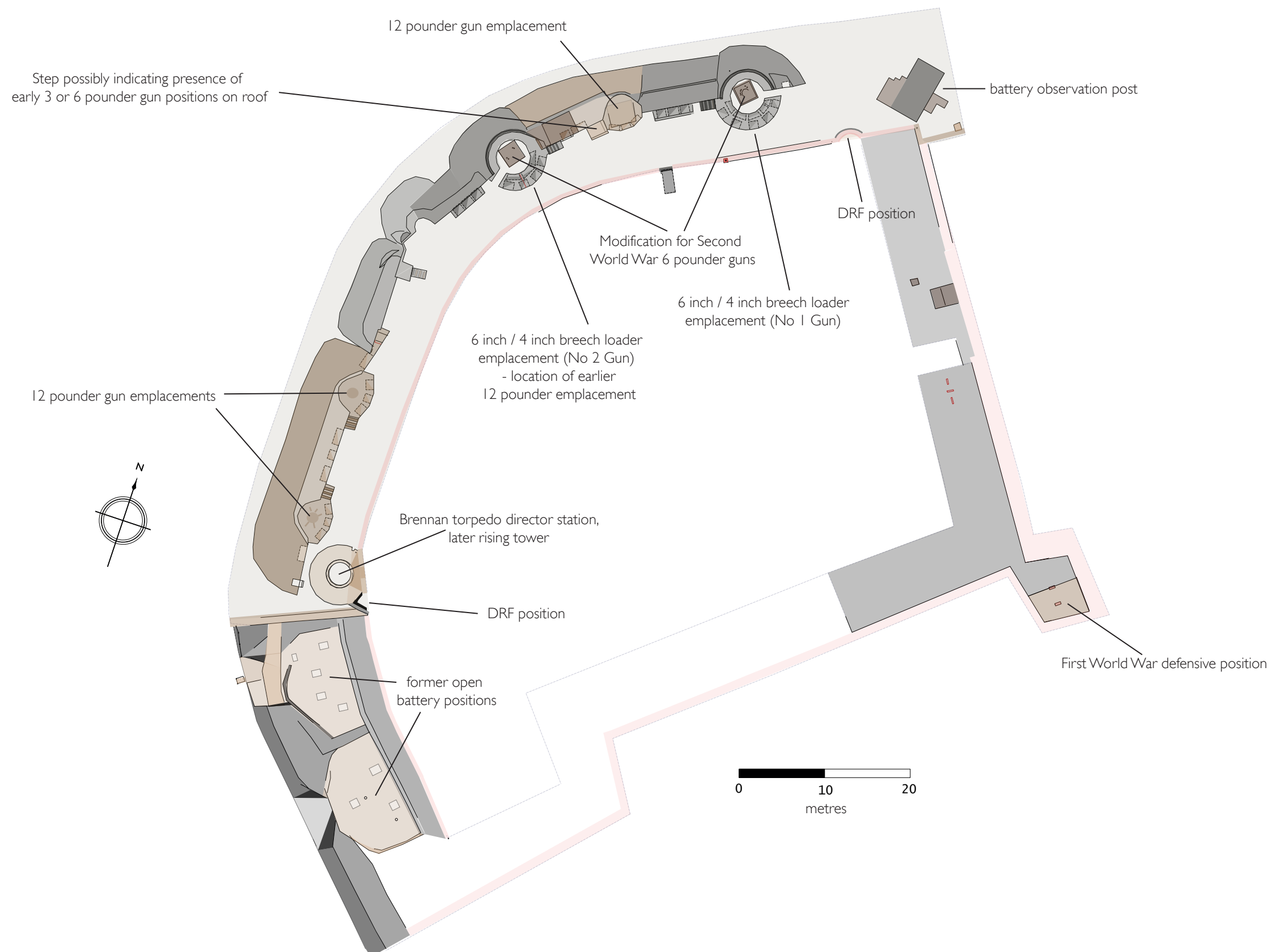

Appendix Figure 8: Plan of roof based on measured survey and the 1899 plan (TNA: WO78/4963). (NB Original and mid-19th century fabric in grey and pink, 12 pounder battery in brown, Brennan installation in cream, 6 inch battery in dark grey, Second World War additions in dark brown, areas of measured survey outlined in black).