

**Archaeological Watching Brief Report  
41 Greenhill Road  
Otford, Kent**

**NGR: (TQ) 553519 160104**

**ASE Project No: 6390  
Site Code: GRR 13**

**ASE Report No: 2013260  
OASIS id: archaeol6-161609**

**By Gary Webster**

**Archaeological Watching Brief Report  
41 Greenhill Road  
Otford, Kent**

**NGR: (TQ) 553519 160104**

**ASE Project No: 6390  
Site Code: GRR 13**

**ASE Report No: 2013260  
OASIS id: archaeol6-161609**

**By Gary Webster**

**October 2013**

**Archaeology South-East  
Units 1 & 2  
2 Chapel Place  
Portslade  
East Sussex  
BN41 1DR**

**Tel: 01273 426830  
Fax: 01273 420866  
Email: [fau@ucl.ac.uk](mailto:fau@ucl.ac.uk)**

**Abstract**

*Archaeology South-East was commissioned by Neil Richardson of NPR Associates on behalf of Svetlana Sapozhnikova to undertake an archaeological watching brief at 41 Greenhill Road, Otford, Kent. No archaeological features or finds were recorded. Only features of modern origin were recorded cutting into the natural stratigraphy. A colluvial layer was identified overlying the natural chalk, beneath the topsoil.*

## **CONTENTS**

- 1.0 Introduction**
- 2.0 Archaeological Background**
- 3.0 Archaeological Methodology**
- 4.0 Results**
- 5.0 Discussion and Conclusions**

**Bibliography**  
**Acknowledgements**

**HER Summary Sheet**  
**OASIS Form**

## **TABLES**

Table 1: Summary of HER find types from within 500m radius of the site  
Table 2: Quantification of site archive  
Table 3: List of recorded contexts

## **FIGURES**

Figure 1: Site location  
Figure 2: Excavated area  
Figure 3: Site photographs

## **1.0 INTRODUCTION**

### **1.1 Site Background**

- 1.1.1 Archaeology South-East (ASE), the contracting division of the Centre for Applied Archaeology (CAA), Institute of Archaeology (IoA), University College London (UCL) was commissioned by Neil Richardson of NPR Associates on behalf of Svetlana Sapozhnikova to undertake an archaeological watching brief at 41 Greenhill Road, Otford, Kent, (Figure 1, NGR: TQ 53519 60104).

### **1.2 Geology and Topography**

- 1.2.1 The site is located near the base of the south-facing scarp slope of the North Downs and is set within a coombe overlooking the River Darent as it passes through the village of Otford (ASE, 2008). The site is in the front garden of a house on Greenhill Road, to the east of the A225 and to the north of the M26. There is a significant height difference between the back of the property and the front, as the site slopes down toward the road.
- 1.2.2 The British Geological Website lists the bedrock geology as being formed of the Holywell Nodular Chalk Formation and New Pit Chalk Formation, which was verified on site.

### **1.3 Planning Background**

- 1.3.1 A generic Kent County Council specification for an archaeological watching brief (KCC, 2011) was submitted to the Local Planning Authority, Sevenoaks District Council, and was approved.
- 1.3.2 ASE was approached to provide the resources for an archaeological watching brief on the area.
- 1.3.3 ASE has previously carried out a watching brief on the property adjacent on the west of the site. A report detailing the findings of this watching brief was produced in March 2008.

### **1.4 Aims and Objectives**

- 1.4.1 The general aims and objectives of the watching brief are:
- Assessing the likely impact of the proposed development on any archaeological remains
  - Mitigating against the destruction of any archaeological remains should they be found on site
  - Assessing the potential of the site to contain nationally important remains
  - To excavate, record and interpret any archaeology found and integrate it into the archaeological landscape

## **1.5 Scope of Report**

- 1.5.1 This report outlines the results of the work carried out on the 9<sup>th</sup> October 2013, by Gary Webster (Archaeologist).

## **2.0     ARCHAEOLOGICAL BACKGROUND**

- 2.0.1     The following archaeological background is drawn from earlier work in the area and the HER search for that work (ASE 2008).

### **2.1     Prehistoric**

- 2.1.1     A Middle Bronze Age collared urn, complete with cremation (Site number 6, table 1) was found during mechanical levelling for a tennis court in the garden of number 46 Greenhill Road. Further investigations were undertaken by the Otford and District Historical Society's Archaeological Group, revealing Early to Middle Bronze Age occupation deposits which themselves capped a Neolithic feature.
- 2.1.2     Otford Mount Bronze Age barrow is the only Scheduled Monument in the vicinity, located a little over 500 metres to the south east of the site.

### **2.2     Post Medieval**

- 2.2.1     A review of the historic maps point to Greenhill Road and the first surrounding houses being built between 1910 and 1938, and that comprises the first modern occupation of the area. Maps that date back further even earlier show the area as being open fields.

### **2.3     Previous Work**

- 2.3.1     Two possible quarry pits of an unknown date were recorded during an archaeological watching brief carried out during work at the property directly to the east of the site. It is concluded that they are most likely natural depressions.

### 2.3 HER search of a radius of 500m

Site Number	Find type	HER Number	Period
1	Flint implement	TQ55 NW24 – MKE321	Undated
2	Handaxe	TQ55 NW35 – MKE332	Undated
3	Pottery and tile	TQ56 SW5 – MKE671	Romano-British
4	Flint Implements	TQ56 SW9 – MKE675	Mesolithic/Neolithic
5	Microlith	TQ56 SW21 – MKE687	Mesolithic
6	Settlement, cinerary urn	TQ56 SW27 – MKE693	Neolithic-Bronze Age
7	Scraper	TQ56 SW44 – MKE710	Undated
8	Flint implements	TQ56 SW46 – MKE712	Undated
9	Scraper	TQ56 SW47 – MKE713	Undated
10	Flint implements	TQ56 SW54 – MKE720	Undated
11	Flint implement	TQ56 SW55 – MKE721	Undated
12	PR Scraper	TQ56 SW64 – MKE730	Undated
13	Flint implements	TQ56 SW65 – MKE731	Undated
14	Flint Implement	TQ56 SW67 – MKE733	Undated

Table 1: Summary of HER find types from within 500m radius of the site



### **3.0 ARCHAEOLOGICAL METHODOLOGY**

#### **3.1 Fieldwork Methodology**

3.1.1 ASE was not present during the machine excavation of an area in the front garden of the property measuring roughly 11.4m by 6.4m (Figure 2). However, we attended the site to view the excavated area which was still open at the time of the visit. The deepest part of the excavation was at the north end of the site, which reached depths of 2.5m, as seen in the photographs on Figure 3.

3.1.2 Further excavation that was to take place under the concrete drive to the north was not monitored, as it was deemed that it would be significantly truncated, by the drive itself and by existing terracing into the hill.

#### **3.2 The Site Archive**

3.2.1 ASE informed Sevenoaks Museum prior to the commencement of fieldwork that a site archive would be generated. They are not currently collecting archives and so the archive is currently held at the offices of ASE and will be deposited at a suitable museum in due course.

Number of Contexts	5
No. of files/paper record	1
Photographs	23

Table 2: Quantification of site archive

## 4.0 RESULTS

- 4.1 A single area measuring 11.4m by 6.4m was excavated in the front garden of the property without archaeological attendance. ASE did however visit the site and view the base of the excavated area and any exposed sections. The following results were recorded.

Context	Type	Description	Max. Length m	Max. Width m	Deposit Thickness m
01	Layer	Garden Soil	11.4	6.4	0.3
02	Layer	Colluvium	11.4	6.4	1.2
03	Layer	Natural geology	11.4	6.4	1.4
04	Cut	Modern disturbance	2.6	-	0.7
05	Fill	Modern disturbance	2.6	-	0.7

Table 3: List of recorded contexts

- 4.2 No archaeological features or finds were recorded. The following sequence was recorded.
- 4.3 Compact, off white natural chalk [03] was recorded across the base of the entire excavated area. This was apparently overlain by a layer of colluvium [04], a compact fine chalk, pale orange with white flecks, and occasional flint inclusions, and was looked completely sterile.
- 4.4 The colluvium was overlain by a garden soil [01], a loose pale grey silty clay. There were frequent episodes of bioturbation visible in the sections, particularly to the west of the site, where the excavated area runs alongside a hedgerow.
- 4.5 In one of the sections (Figure 3.4), towards the south-east of the excavated area an area of modern disturbance was visible. The disturbance was cut [04] sharply into the natural with the northern edge leading almost vertically down to a rounded break of slope at the bottom, leading to a flat base. It was 0.7m deep, and was at least 2.6m in length where it began to taper out. The fill [05] was a fairly compact mix deposit of greyish brown silty clay, and off-white chalk. Large pieces of modern metal were identified to the far south of the feature.
- 4.6 Towards the south-west the stratigraphy had also been visibly disturbed by the construction/demolition of a garage which stood on the area.

## **5.0 DISCUSSION AND CONCLUSIONS**

- 5.1 No archaeological features or finds were recorded. Only features of modern origin were recorded cutting into the natural stratigraphy. This is most likely disturbance from the construction of the houses, between 1910 and 1938 and a more recent garage.
- 5.2 A colluvial layer was identified overlying the natural chalk and beneath topsoil. This deposit was previously recorded in excavations carried out to the immediate east which assessed that the colluvium filled a natural topographic depression and is not the result of quarrying or deliberate human activity (ASE 2008). The present watching brief results appear to corroborate with this interpretation.

## BIBLIOGRAPHY

ASE 2008. An Archaeological Watching Brief at 39 Greenhill Road, Otford, Kent.

British Geological Survey website accessed on 16/10/13: [www.bgs.ac.uk](http://www.bgs.ac.uk)

Kent County Council 2011. *Standard Specification for an Archaeological Watching Brief/evaluation/excavation*

MoLAS 1994. *Site Manual for Archaeological Fieldwork*

Pyke, J.A. 1980. 'Greenhill Bronze Age Site, Otford' in *Archaeologia Cantiana Vol. XCVI*: pp.321-339

Pyke, J.A. & Ward. C.P. 1975. 'A Middle Bronze Age Burial at Otford' in *Archaeologia Cantiana Vol. XCI*: pp.185-187

British Geological Survey website accessed on 16/10/13: [www.bgs.ac.uk](http://www.bgs.ac.uk)

## ACKNOWLEDGEMENTS:

ASE would like to thank Svetlana Sapozhnikova for commissioning the work and Greg Chuter of ESCC for his assistance throughout the project. Justin Russell produced the figures for this report; Neil Griffin project managed the excavations and Jim Stevenson and Dan Swift project managed the post-excavation process.

## HER Summary Form

Site Code	GRR1 3					
Identification Name and Address	41 Greenhill Road, Otford, Kent					
County, District &/or Borough	Sevenoaks					
OS Grid Refs.	(TQ) 553519 160104					
Geology	Holywell Nodular Chalk Formation and New Pit Chalk Formation					
Arch. South-East Project Number	2013260					
Type of Fieldwork	Eval.	Excav.	Watching Brief ✓	Standing Structure	Survey	Other
Type of Site	Green Field	Shallow Urban ✓	Deep Urban	Other		
Dates of Fieldwork	Eval.	Excav.	WB. 9 / 10 / 13	Other		
Sponsor/Client	Svetlana Sapozhnikova					
Project Manager	Neil Griffin					
Project Supervisor	Gary Webster					
Period Summary	Palaeo.	Meso.	Neo.	BA	IA	RB
	AS	MED	PM	Other Modern		
<p><b>Summary</b></p> <p>Archaeology South-East was commissioned by Neil Richardson of NPR Associates on behalf of Svetlana Sapozhnikova to undertake an archaeological watching brief at 41 Greenhill Road, Otford, Kent.</p> <p>No archaeological features or finds were recorded. Only features of modern origin were recorded cutting into the natural stratigraphy. This is most likely disturbance from the construction of the houses, between 1910 and 1938 and a more recent garage. A colluvial layer was identified overlying the natural chalk and beneath topsoil. This deposit was previously recorded in excavations carried out to the immediate east which assessed that the colluvium filled a natural topographic depression and is not the result of quarrying or deliberate human activity (ASE 2008). The present watching brief results appear to corroborate with this interpretation.</p>						

## OASIS Form

**OASIS ID: archaeol6-161609**

Project name	An archaeological watching brief at 41 Greenhill Road, Otford, Kent
Short description of the project	<p>Archaeology South-East was commissioned by Neil Richardson of NPR Associates on behalf of Svetlana Sapozhnikova to undertake an archaeological watching brief at 41 Greenhill Road, Otford, Kent.</p> <p>No archaeological features or finds were recorded. Only features of modern origin were recorded cutting into the natural stratigraphy. This is most likely disturbance from the construction of the houses, between 1910 and 1938 and a more recent garage. A colluvial layer was identified overlying the natural chalk and beneath topsoil. This deposit was previously recorded in excavations carried out to the immediate east which assessed that the colluvium filled a natural topographic depression and is not the result of quarrying or deliberate human activity (ASE 2008). The present watching brief results appear to corroborate with this interpretation.</p>
Project dates	Start: 09-10-2013 End: 09-10-2013
Previous/future work	Yes / No
Any associated project reference codes	GRR 13 - Sitecode
Type of project	Recording project
Site status	None
Current Land use	Other 5 - Garden
Investigation type	"Watching Brief"

Site location	KENT SEVENOAKS OTFORD 41 Greenhill Road
Postcode	TN14 5RR
Study area	73.00 Square metres
Site coordinates	NGR - TQ 53519 60104 LL - 51 0 (decimal) LL - 51 19 07 N 000 12 11 E (degrees) Point

Name of Organisation	Archaeology South-East
Project brief originator	Private Client

Project director/manager	Neil Griffin
Project supervisor	Gary Webster
Type of sponsor/funding body	Private

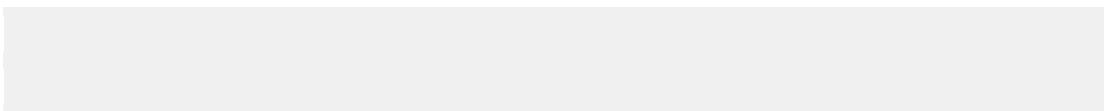

Physical Archive Exists?	No
--------------------------	----



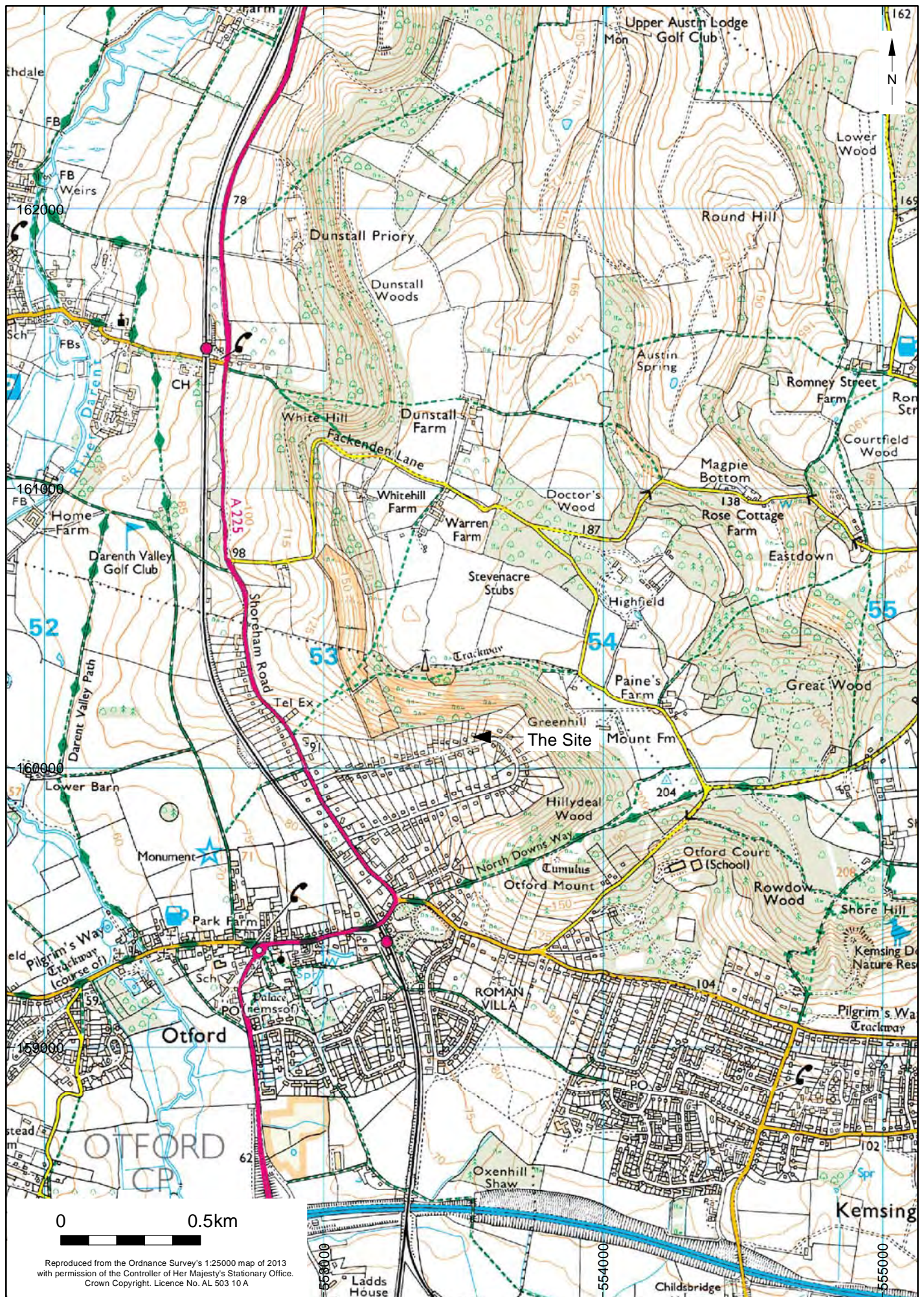

© Archaeology South-East		41 Greenhill Road, Otford, Kent	Fig. 1
Project Ref: 6390	October 2013	Site location	
Report Ref: 2013260	Drawn by: RHC		



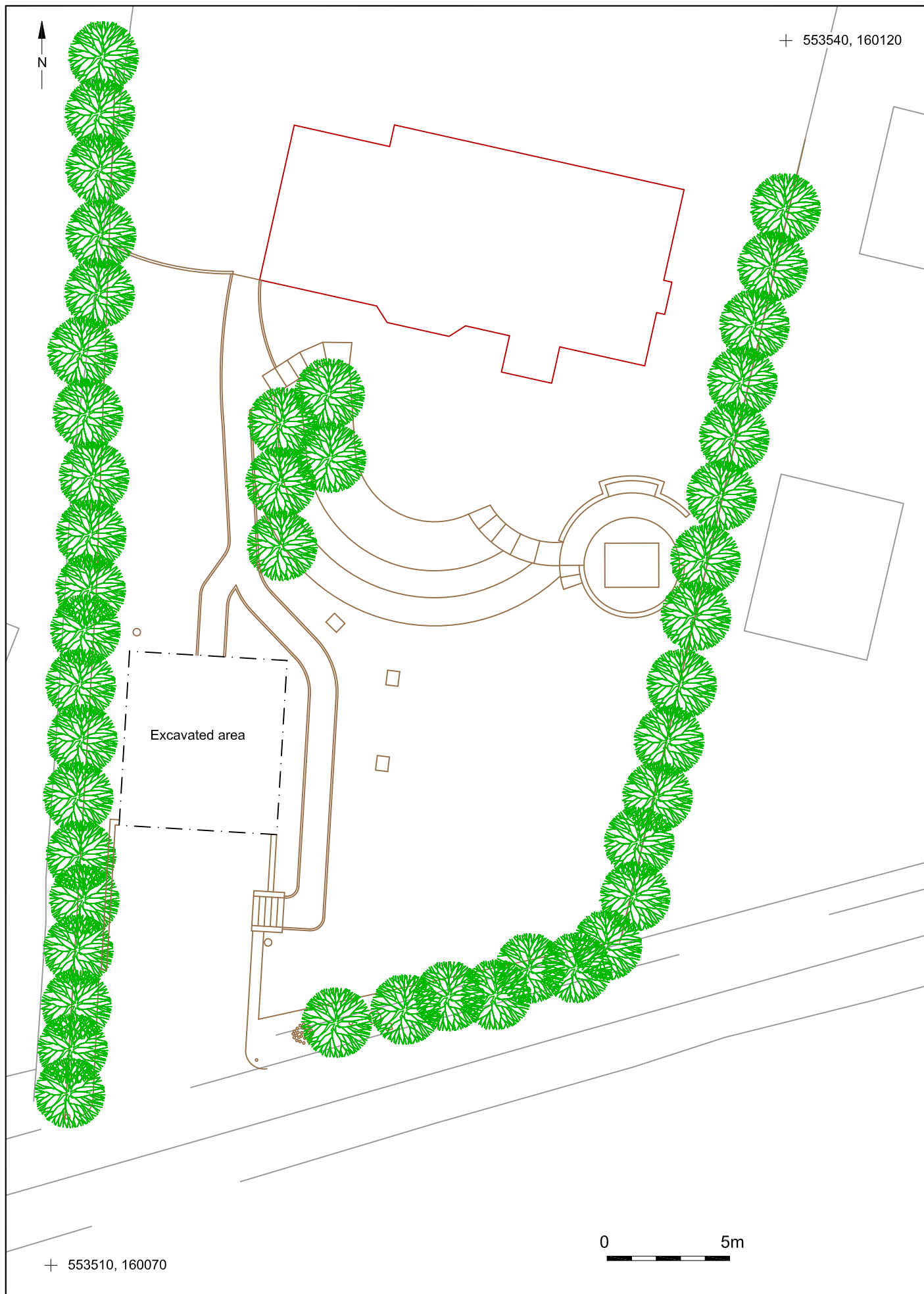

© Archaeology South-East		41 Greenhill Road, Otford, Kent	Fig. 2
Project Ref: 6390	October 2013	Excavated area	
Report Ref: 2013260	Drawn by: RHC		



Fig. 3.1 Excavated area looking north



Fig. 3.2 West facing section



Fig. 3.3 South facing section



Fig. 3.4 East facing section

Head Office  
Units 1 & 2  
2 Chapel Place  
Portslade  
East Sussex BN41 1DR  
Tel: +44(0)1273 426830 Fax: +44(0)1273 420866  
email: [fau@ucl.ac.uk](mailto:fau@ucl.ac.uk)  
Web: [www.archaeologyse.co.uk](http://www.archaeologyse.co.uk)



London Office  
Centre for Applied Archaeology  
Institute of Archaeology  
University College London  
31-34 Gordon Square, London, WC1 0PY  
Tel: +44(0)20 7679 4778  
Fax: +44(0)20 7383 2572  
Web: [www.ucl.ac.uk/caa](http://www.ucl.ac.uk/caa)

The contracts division of the Centre for Applied Archaeology, University College London 

©Archaeology South-East